

TO BE BETTER



Hearing Aids

CERTIFIED PRODUCT |     

PRODUCT BROCHURE

2018 - 2019

AGS-Medical

Tel: 505-550-6501 & 505-565-5102

Fax: 505-814-5778

Email: sales@agsmedical.com

Web: <http://www.agsmedical.com>



PRODUCT DESCRIPTION

Main Product	02
Series Product	04
Digital Hearing Aid	11
Analog Hearing Aid	12
Behind the Ear Hearing Aid	13
Rechargeable Hearing Aid	16
In the Ear Hearing Aid	18
Bluetooth Shape Hearing Aid	19
Pocket Body Hearing Aid	19

CERTIFIED
PRODUCT



CE



Waterproof technology

JHD19



SPECIFICATION:

MAX SOUND OUTPUT : 113±3DB

SOUND GAIN: 37±5DB

TOTAL HARMONIC WAVE DISTORTION:≤1.8%

FREQUENCY RANGE: 200-7300HZ

INPUT NOISE: ≤18.8DB

VOLTAGE: D.C.1.5V

CURRENT: ≤1.2MA

BATTERY SIZE: A312



Normal mode



Noise reduction mode



Outdoor mode



Conference mode

FEATURES:

4 Channel digital machine, 4 modes for different environment (Normal, Noise Reduction, Indoor, Outdoor).

Rocker Switch

Wide dynamic range compression WDRC processing, Automatic Antireaction

Water proof and dust proof, IP68

Compatible for both earhook, user can replace easily.

JHD18

SPECIFICATION:

MAX SOUND OUTPUT: 125±3DB
SOUND GAIN: ≥35±5DB
TOTAL HARMONIC WAVE DISTORTION: ≤3%
FREQUENCY RANGE: 200-5000HZ
INPUT NOISE: ≤30DB
VOLTAGE: D.C.1.4V
CURRENT: ≤3MA
BATTERY SIZE: A312



Normal mode



Noise reduction mode



Telecoil

FEATURES:

4 Channel digital machine, 3 modes for different environment (Normal, Noise Reduction, Telecoil).
Frequency can be control by N and H, MPO adjustment.
Patients can improve the listening comprehension by switching modes under different conditions.
Complete Digital Signal Processor(DSP), Automatic Antireaction, Wide dynamic range compression WDRC processing.

JHD16-00F

SPECIFICATION:

MAX SOUND OUTPUT: 122±3DB
SOUND GAIN: 37DB±5
TOTAL HARMONIC WAVE DISTORTION: ≤1.5%
FREQUENCY RANGE: 200-5700HZ
INPUT NOISE: ≤15DB
VOLTAGE: D.C.1.5V
CURRENT: ≤2MA
BATTERY SIZE: A312



JHD16-04F

SPECIFICATION:

MAX SOUND OUTPUT: 125±3DB
SOUND GAIN: 40DB±5
TOTAL HARMONIC WAVE DISTORTION: ≤3%
FREQUENCY RANGE: 200-5000HZ
INPUT NOISE: ≤20DB
VOLTAGE: D.C.1.5V
CURRENT: ≤2MA
BATTERY SIZE: A312



Normal mode



Noise reduction mode



Outdoor mode



Conference mode

FEATURES:

4 Channel digital machine, 4 modes for different environment (Normal, Noise Reduction, Indoor, Outdoor).
Patients can improve the listening comprehension by switching modes under different conditions.
Complete Digital Signal Processor(DSP), Automatic Antireaction, Wide dynamic range compression WDRC processing.

SERIES PRODUCT

JH361



SPECIFICATION:

MAX SOUND OUTPUT: 130±3DB
SOUND GAIN: ≥35±5DB
TOTAL HARMONIC WAVE DISTORTION: ≤6%
FREQUENCY RANGE: 300-5500HZ
INPUT NOISE: ≤32DB
VOLTAGE: D.C.3.7V
CURRENT: ≤3MA
BATTERY:3.7V 30MAH BUILT-IN LITHIUM BATTERY

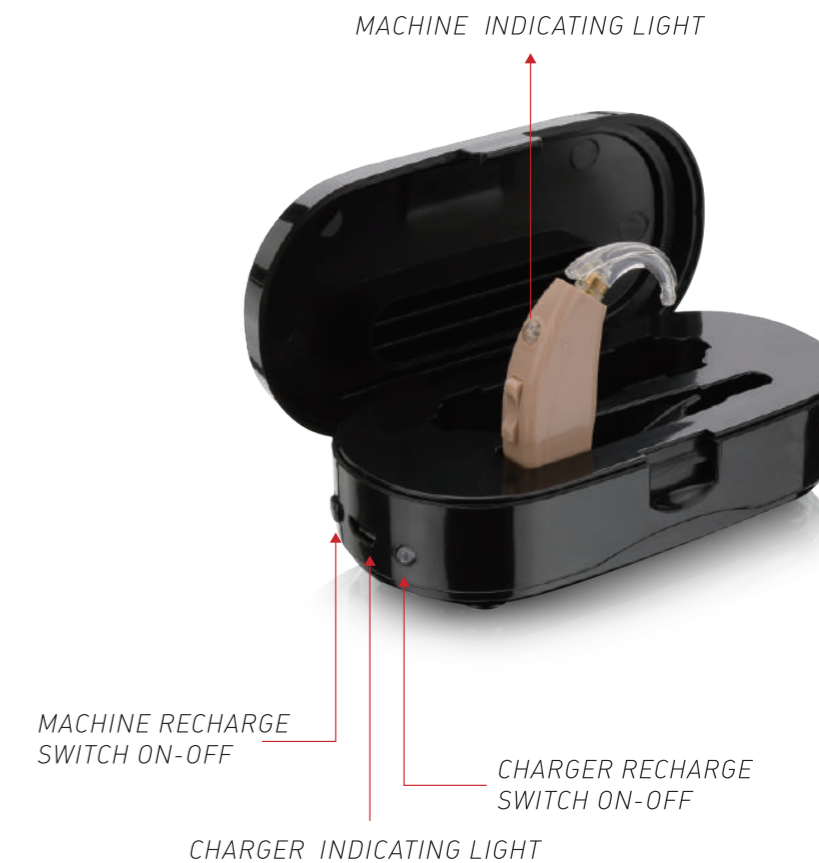

FEATURES:

Up to 8 times recharge the unit when the charger base is full recharged.
Needs only 90 minutes to full recharged the base and unit.
Perform as a power bank of hearing aids.
Two modes Control, On-Off press button, available for USB cable recharge.

JH351

SPECIFICATION:
MAX SOUND OUTPUT: 130±3DB
SOUND GAIN: 35±5DB
TOTAL HARMONIC WAVE DISTORTION:≤6%
FREQUENCY RANGE: 300-5500HZ
INPUT NOISE: ≤32DB
VOLTAGE: D.C.3.7V
CURRENT: ≤3MA
BATTERY: 3.7V 30MAH BUILT-IN LITHIUM BATTERY



JH351R

SPECIFICATION:
MAX SOUND OUTPUT: 125±3DB
SOUND GAIN: 36±5DB
TOTAL HARMONIC WAVE DISTORTION:≤10%
FREQUENCY RANGE: 200-5000HZ
INPUT NOISE: ≤32DB
VOLTAGE: D.C.3.7V
CURRENT: ≤3MA

FEATURES:
SUPER MINI IN THE EAR, INVISIBLE IN THE EAR.
WIDE FREQUENCY RANGE, HIGH QUALITY SOUND.
OPEN FIT HEARING AID, NO BLOCKAGE EFFECT,
IMPROVING WEAR COMFORT.



JH351O

SPECIFICATION:
MAX SOUND OUTPUT: 130±3DB
SOUND GAIN: 35±5DB
TOTAL HARMONIC WAVE DISTORTION:≤6%
FREQUENCY RANGE: 300-5500HZ
INPUT NOISE: ≤32DB
VOLTAGE: D.C.3.7V
CURRENT: ≤3MA
BATTERY: 3.7V 30MAH BUILT-IN LITHIUM BATTERY



JHD03

SPECIFICATION:
MAX SOUND OUTPUT: 130±3DB
SOUND GAIN: 40DB±5
TOTAL HARMONIC WAVE DISTORTION: ≤6%
FREQUENCY RANGE: 400-4000HZ
INPUT NOISE: ≤32DB
VOLTAGE: D.C.1.5V
CURRENT: ≤3MA
BATTERY:LR754



JHD04

SPECIFICATION:
MAX SOUND OUTPUT: 125±3DB
SOUND GAIN: 35±5DB
TOTAL HARMONIC WAVE DISTORTION:≤10%
FREQUENCY RANGE: 300-5000HZ
INPUT NOISE: ≤30DB
VOLTAGE: D.C.1.5V
CURRENT: ≤3MA
BATTERY SIZE: LR754



SERIES PRODUCT



DIGITAL HEARING AID

JHD101



SPECIFICATION:
MAX SOUND OUTPUT: 128±3DB
SOUND GAIN: 57±5DB
TOTAL HARMONIC WAVE DISTORTION:≤6%
FREQUENCY RANGE: 200-5500HZ
INPUT NOISE: ≤20DB
VOLTAGE: D.C.1.4V
CURRENT: ≤2MA
BATTERY SIZE:A675



JH908



SPECIFICATION:
MAX SOUND OUTPUT: 115±3DB
SOUND GAIN: 30±5DB
TOTAL HARMONIC WAVE DISTORTION:≤6%
FREQUENCY RANGE: 300-7500HZ
INPUT NOISE: ≤32DB
VOLTAGE: D.C.1.35V
CURRENT: ≤2MA
BATTERY SIZE: A10



DIGITAL HEARING AID

ANALOG HEARING AID

ANALOG HEARING AID

JH168

SPECIFICATION:

MAX SOUND OUTPUT: 125±3DB
SOUND GAIN: 35±5DB
TOTAL HARMONIC WAVE DISTORTION:≤6%
FREQUENCY RANGE: 300-5500HZ
INPUT NOISE: ≤32DB
VOLTAGE: D.C.1.5V
CURRENT: ≤3MA
BATTERY SIZE: LR754



JH180

SPECIFICATION:

MAX SOUND OUTPUT: 125±5DB
SOUND GAIN: 35±5DB
TOTAL HARMONIC WAVE DISTORTION:≤6%
FREQUENCY RANGE: 300-4000HZ
INPUT NOISE: ≤30DB
VOLTAGE: D.C.1.5V
CURRENT: ≤3MA
BATTERY SIZE: LR754



BEHIND THE EAR HEARING AID

JH116

SPECIFICATION:

MAX SOUND OUTPUT: 126±3DB
SOUND GAIN: 32±5DB
TOTAL HARMONIC WAVE DISTORTION:≤10%
FREQUENCY RANGE: 400-4500HZ
INPUT NOISE: ≤32DB
VOLTAGE: D.C.1.5V
CURRENT: ≤3MA
BATTERY SIZE: LR754



JH115

SPECIFICATION:

MAX SOUND OUTPUT: 125±3DB
SOUND GAIN: 35±5DB
TOTAL HARMONIC WAVE DISTORTION:≤10%
FREQUENCY RANGE: 300-3500HZ
INPUT NOISE: ≤32DB
VOLTAGE: D.C.1.5V
CURRENT: ≤4.5MA
BATTERY SIZE: LR754



JH301

SPECIFICATION:

MAX SOUND OUTPUT: 125±5DB
SOUND GAIN: 35±5DB
TOTAL HARMONIC WAVE DISTORTION:≤6%
FREQUENCY RANGE: 300-5200HZ
INPUT NOISE: ≤32DB
VOLTAGE: D.C.1.5V
CURRENT: ≤3MA
BATTERY SIZE: LR754



JH158

SPECIFICATION:

MAX SOUND OUTPUT: 135±3DB
SOUND GAIN: 35±5DB
TOTAL HARMONIC WAVE DISTORTION:≤6%
FREQUENCY RANGE: 200-4000HZ
INPUT NOISE: ≤30DB
VOLTAGE: D.C.1.5V
CURRENT: ≤6.5MA
BATTERY SIZE: LR754



JH125

SPECIFICATION:

MAX SOUND OUTPUT: 125±3DB
SOUND GAIN: 35±5DB
TOTAL HARMONIC WAVE DISTORTION:≤10%
FREQUENCY RANGE: 300-3500HZ
INPUT NOISE: ≤32DB
VOLTAGE: D.C.1.5V
CURRENT: ≤4.5MA
BATTERY SIZE: LR754



JH113

SPECIFICATION:

MAX SOUND OUTPUT: 127±3DB
SOUND GAIN: 47±5DB
TOTAL HARMONIC WAVE DISTORTION:≤10%
FREQUENCY RANGE: 300-3000HZ
INPUT NOISE: ≤30DB
VOLTAGE: D.C.1.5V
CURRENT: ≤4.5MA
BATTERY SIZE: LR44H



JH117

SPECIFICATION:

MAX SOUND OUTPUT: 129±3DB
SOUND GAIN: 35±5DB
TOTAL HARMONIC WAVE DISTORTION:≤10%
FREQUENCY RANGE: 300-3500HZ
INPUT NOISE: ≤32DB
VOLTAGE: D.C.1.5V
CURRENT: ≤4.5MA
BATTERY SIZE: LR44H



JH909

SPECIFICATION:

MAX SOUND OUTPUT: 115±3DB
SOUND GAIN: 27±5DB
TOTAL HARMONIC WAVE DISTORTION:≤6%
FREQUENCY RANGE: 200-4500HZ
INPUT NOISE: ≤32DB
VOLTAGE: D.C.3.7V
CURRENT: ≤2MA



JH905

SPECIFICATION:

Max Sound Output: 120±3dB
Sound Gain: 30±5dB
Total Harmonic Wave Distortion:≤10%
Frequency Range: 200-5000Hz
Input Noise: ≤30dB
Voltage: D.C.1.5V
Current: ≤3mA



JH335

SPECIFICATION:

Max Sound Output: 125±3dB
Sound Gain: 25±5dB
Total Harmonic Wave Distortion:≤5%
Frequency Range: 200-4000Hz
Input Noise: ≤25dB
Voltage: D.C.1.5V
Current: ≤5mA



JH338-3/JH338-4

SPECIFICATION:

MAX SOUND OUTPUT: 125±3DB
SOUND GAIN: 35±5DB
TOTAL HARMONIC WAVE DISTORTION:≤10%
FREQUENCY RANGE: 300-3500HZ
INPUT NOISE: ≤32DB
VOLTAGE: D.C.1.5V
CURRENT: ≤5MA



JH337

SPECIFICATION:

MAX SOUND OUTPUT: 135±3DB
SOUND GAIN: 30±5DB
TOTAL HARMONIC WAVE DISTORTION:≤10%
FREQUENCY RANGE: 300-5000HZ
INPUT NOISE: ≤30DB
VOLTAGE: D.C.1.35V
CURRENT: ≤5MA



RECHARGEABLE

JH907

SPECIFICATION:
MAX SOUND OUTPUT: 125±3DB
SOUND GAIN: 30±5DB
TOTAL HARMONIC WAVE DISTORTION:≤10%
FREQUENCY RANGE: 200-3000HZ
INPUT NOISE: ≤30DB
VOLTAGE: D.C.1.5V
CURRENT: ≤3.5MA
BATTERY SIZE: A10



JH906

SPECIFICATION:
MAX SOUND OUTPUT: 128±3DB
SOUND GAIN: 38±5DB
TOTAL HARMONIC WAVE DISTORTION:≤10%
FREQUENCY RANGE: 800-4000HZ
INPUT NOISE: ≤30DB
VOLTAGE: D.C.1.5V
CURRENT: ≤6.5MA
BATTERY SIZE: AG3/A312



JH900A

SPECIFICATION:
MAX SOUND OUTPUT: 125±3DB
SOUND GAIN: ≥50DB
TOTAL HARMONIC WAVE DISTORTION:≤6%
FREQUENCY RANGE: 100-6000HZ
INPUT NOISE: ≤30DB
VOLTAGE: D.C.1.5V
CURRENT: ≤2MA
BATTERY SIZE: A312



JH119

SPECIFICATION:
MAX SOUND OUTPUT: 132±5DB
SOUND GAIN: 40±5DB
TOTAL HARMONIC WAVE DISTORTION:≤5%
FREQUENCY RANGE: 300-5500HZ
INPUT NOISE: ≤25DB
VOLTAGE: D.C.3V
CURRENT: ≤5MA
BATTERY SIZE: LR44H



JH129

SPECIFICATION:
MAX SOUND OUTPUT: 135±3DB
SOUND GAIN: 40±5DB
TOTAL HARMONIC WAVE DISTORTION:≤10%
FREQUENCY RANGE: 300-3500HZ
INPUT NOISE: ≤30DB
VOLTAGE: D.C.3V
CURRENT: ≤6MA
BATTERY SIZE: LR44H



JH233

SPECIFICATION:
MAX SOUND OUTPUT: 135±3DB
SOUND GAIN: 55±5DB
TOTAL HARMONIC WAVE DISTORTION:≤10%
FREQUENCY RANGE: 300-3300HZ
INPUT NOISE: ≤30DB
VOLTAGE: D.C.1.5V
CURRENT: ≤6.5MA
BATTERY SIZE: AA



JH238

SPECIFICATION:
MAX SOUND OUTPUT: 136±3DB
SOUND GAIN: 52±5DB
TOTAL HARMONIC WAVE DISTORTION:≤10%
FREQUENCY RANGE: 400-3500HZ
INPUT NOISE: ≤32DB
VOLTAGE: D.C.1.35V
CURRENT: ≤7.5MA
BATTERY SIZE: AA



ITE